

T.16N.,R.64W.

1/4 Cor. 15  
22

RECEIVED  
LARAMIE COUNTY  
CHEYENNE, WY.

'93 SEP 3 AM 10 30  
126096

CERTIFIED LAND CORNER RECORDATION

DESCRIPTION OF CORNER EVIDENCE FOUND, AND ORIGINAL RECORD (If known)

Original Record: Alfred M. Rodgers, U.S. Deputy Surveyor, July 1871

39.07 Ch Set a quartz boulder 15 x 6 x 6 for 1/4 sec. cor.

Found: 12" x 7" x 4" Quartz stone marked 1/4 on North face and firmly set.

DESCRIPTION OF MONUMENT AND ACCESSORIES ESTABLISHED  
TO PERPETUATE THE ORIGINAL LOCATION OF THIS CORNER:

Set: At the corner point, set a No. 5 x 24" rebar with 2" al. cap mkd. ....  
Set a steel fence post witness approx. 1' south. Buried original  
stone along west side of monument as memorial.

555  
T16N R64W  
1/4 15  
22  
1993  
LS 2927

**RAISED A MOUND OF STONE NORTH.**

SKETCH, WITH COURSE AND DISTANCE TO ADJACENT CORNER IF DETERMINED IN THIS SURVEY.  
(May Sketch or Paste Reproduction on Reverse Side.)

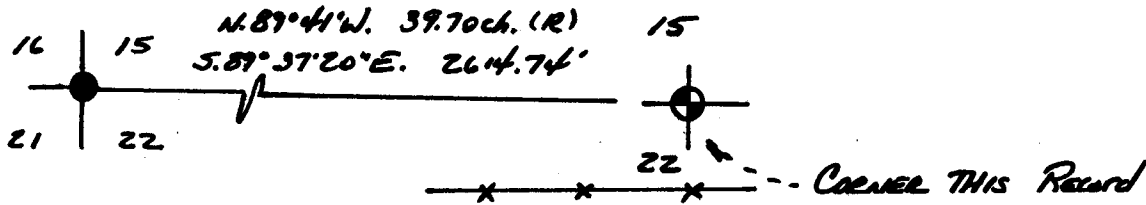

Basis of Bearings: Solar Observation at the nw corner Sec. 20, T.16N. R. 64W.

I, Paul A. Reid certify that I have personally performed or reviewed the work done on the diagrammed corner as reported on this recordation form and approve the same.

Signature of Surveyor

2927  
Registration No.

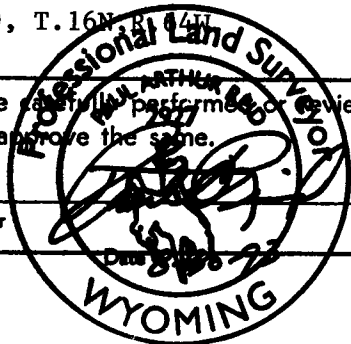

STATE OF WYOMING,  
Office of Clerk and Recorder,  
County of Laramie

This "corner record" was filed for record on the \_\_\_\_\_ day of \_\_\_\_\_, 19\_\_\_\_, was noted on the cross-index plat and is assigned page No. \_\_\_\_\_, in book No. \_\_\_\_\_.

County Official

Cross Index No. <u>N15</u>	T. <u>16N.</u>	R. <u>64W., 6th PMer.</u>
_____	T. _____	R. _____ Mer.
_____	T. _____	R. _____ Mer.
_____	T. _____	R. _____ Mer.
_____	T. _____	R. _____ Mer.
_____	T. _____	R. _____ Mer.
_____	T. _____	R. _____ Mer.

1/4 corner 15  
22

BOOK 1352

1443